



ALLEGAN COUNTY
COUNTY BUILDING RENOVATION

RENDERING
PUBLIC ENTRY
LOOKING SOUTHEAST



LANDMARK DESIGN GROUP, P.C.
3900 LINDEN AVENUE, SE, SUITE C
GRAND RAPIDS, MI 49548-3406

1
6.18.09



ALLEGAN COUNTY
COUNTY BUILDING RENOVATION

FIRST FLOOR - PUBLIC ENTRY

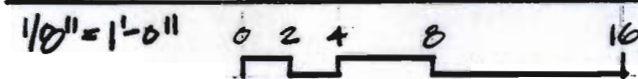

LANDMARK DESIGN GROUP, P.C.
3900 LINDEN AVENUE, SE, SUITE C
GRAND RAPIDS, MI 49548-3406

3
6.18.09

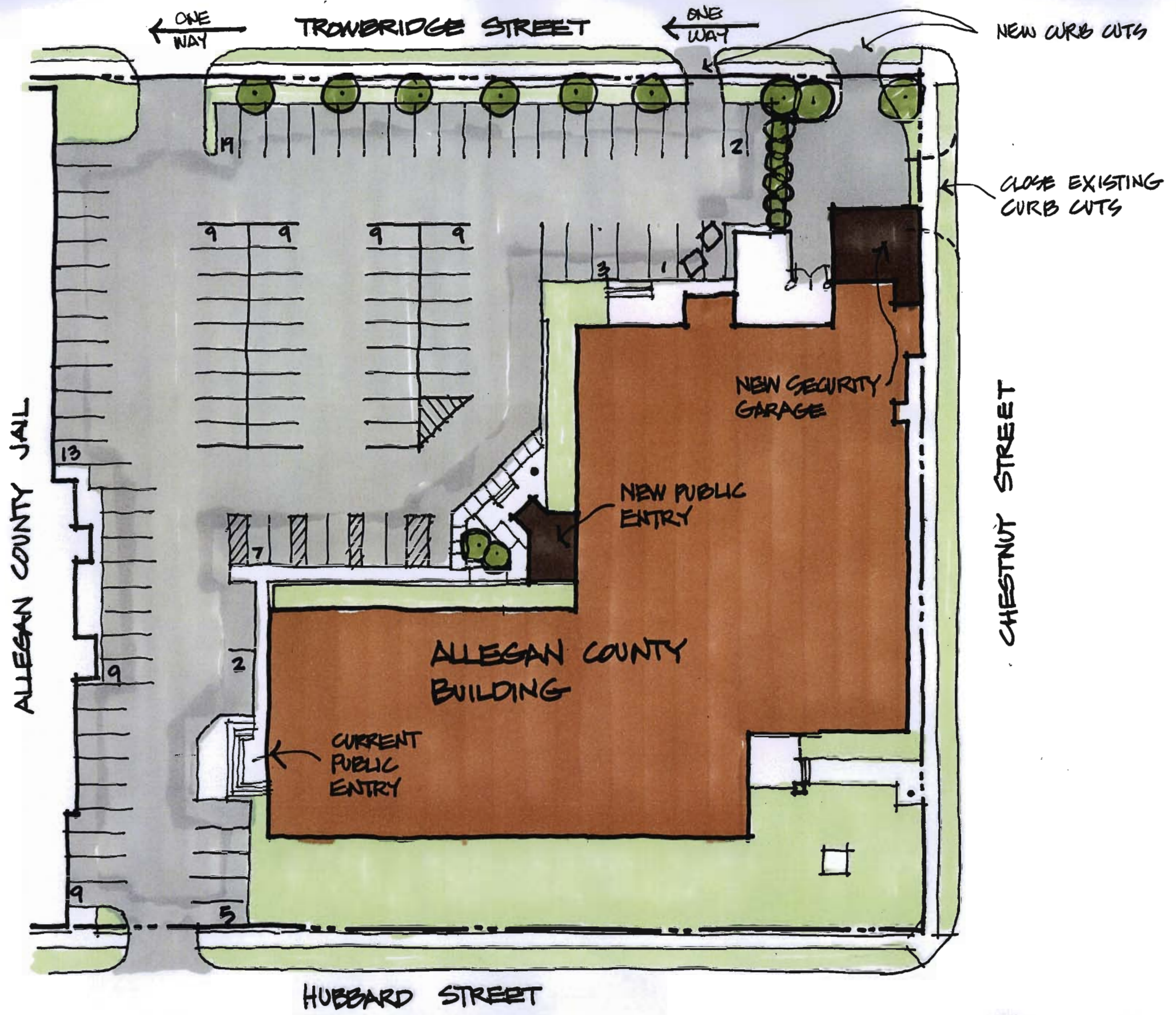

**ALLEGAN COUNTY
COUNTY BUILDING RENOVATION**

SITE PLAN
 1" = 40'-0"
 0 10 20 30 40 50



LANDMARK DESIGN GROUP, P.C.
 3900 LINDEN AVENUE, SE, SUITE C
 GRAND RAPIDS, MI 49548-3406

2
 6.18.09

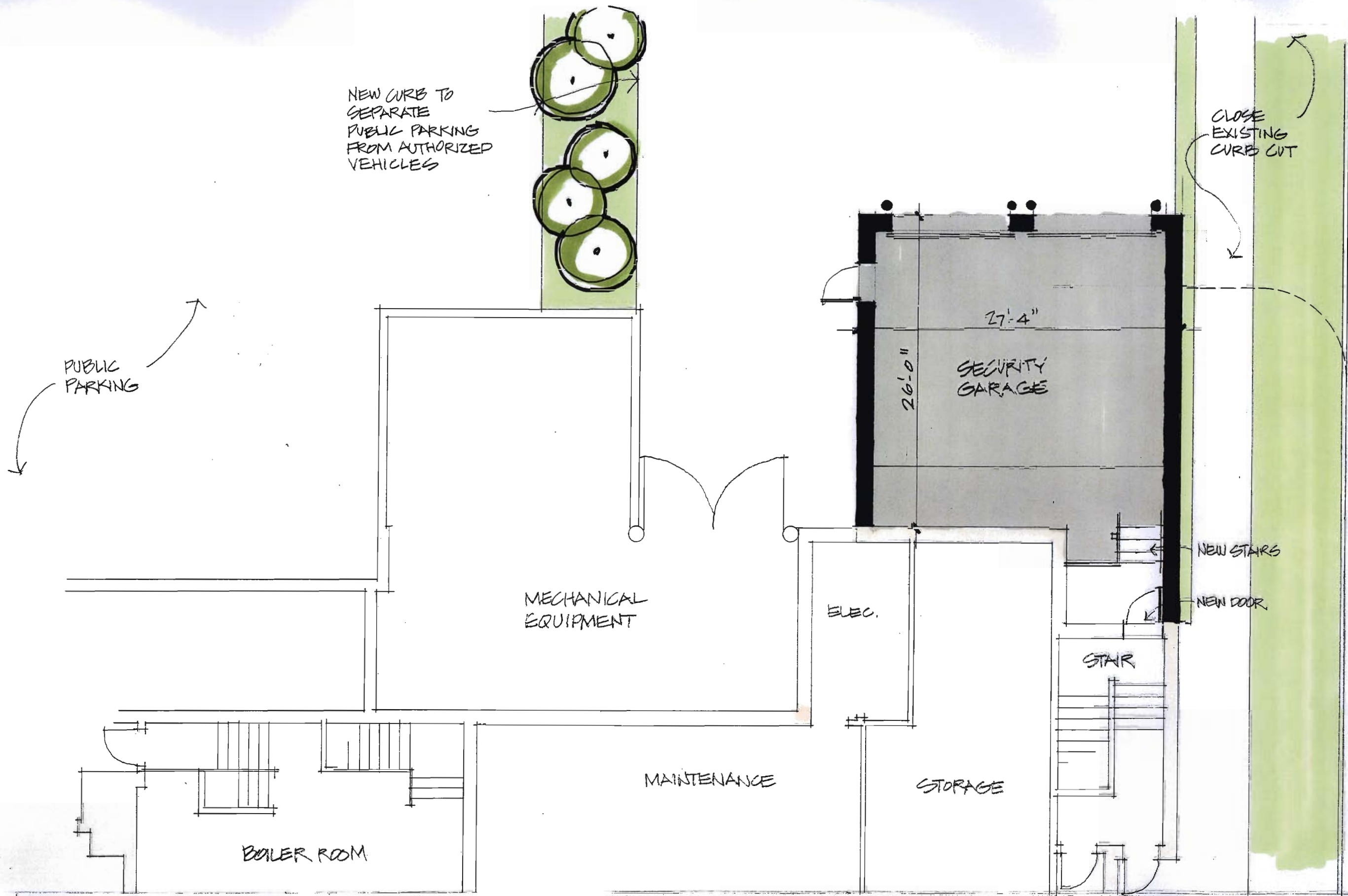

ALLEGAN COUNTY
COUNTY BUILDING RENOVATION

GARDEN LEVEL PLAN
NEW SECURITY GARAGE

1/8" = 1'-0"

0 2 4 8 16

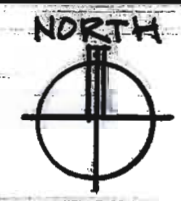

LANDMARK

LANDMARK DESIGN GROUP, P.C.
3900 LINDEN AVENUE, SE, SUITE C
GRAND RAPIDS, MI 49548-3406

4
6-18-09